

LED

TRI-COLOR



EGLO

my light | my style



**ROYSTAR TRI-COLOUR DOWNLIGHT**

203905N – 9W DOWNLIGHT / INTERCHANGEABLE TRIM – COLOUR TEMP CHANGE BY SWITCH ON THE BACKSIDE OF SPOTHEAD

EGLO Lighting Australia, 5/339 Archerfield Road, Richlands, Queensland 4077  
Made in China

Thank you for purchasing a quality EGLO Roystar downlight. Please read the following instructions carefully before installation. Keep this document for future reference.

**WARNING!**

Any electrical wiring must be carried out by a licensed electrician or qualified personnel. Installation must follow all relevant Australian wiring rules & standards.

**INSTALLATION**

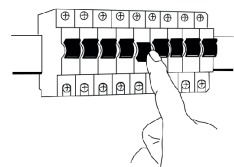

OFF

**1** Turn power off at main electrical supply board.

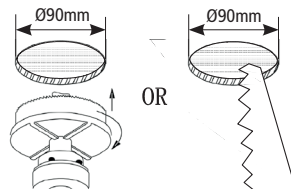

**2** Ensure that there are no cables or pipes in the ceiling cavity above where the downlight is to be installed. Using a 90mm hole saw, carefully cut a hole in the plaster. Use appropriate eye protection, dust mask and appropriate safety apparatus to ensure adequate personal protection.

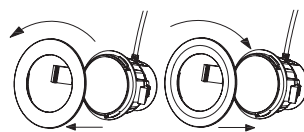

**3** This downlight comes with a plastic white recessed face trim. If changing to an alternative trim (sold separately), remove the existing trim by rotating anti-clockwise and pulling away from the downlight. To attached the new trim, align the slots on the trim with the tabs on the downlight, and twist clockwise to lock into place.

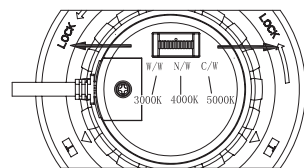

**4** For the model (colour temperature selection switch on back of fitting), set the desired colour temperature (3000K, 4000K or 5000K) by toggling the switch on the back of the downlight BEFORE installation.

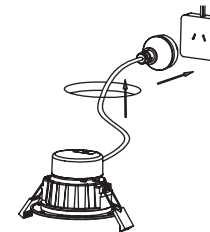

**5** Insert the plug into the power socket located in the ceiling. Please note, if no power socket is present, one will need to be installed by a licenced electrician.

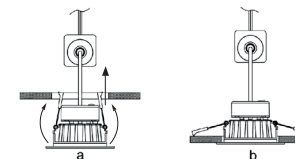

**6** Fold the two side springs back against the downlight body simultaneously, whilst inserting into the pre-cut hole. Once inside the hole, the springs should naturally tense back down onto the top of the plaster ceiling to hold the downlight firmly in place.

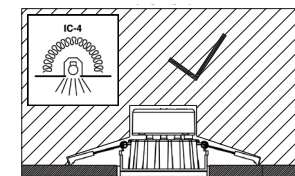

**7** This downlight has been tested and has achieved an IC-4 thermal rating, meaning it can be abutted and covered with thermal insulation in normal use. The minimum clearance distance from the luminaire to any normally flammable building element is 0mm. The minimum clearance distance from the top of the luminaire to any building insulation is 0mm.

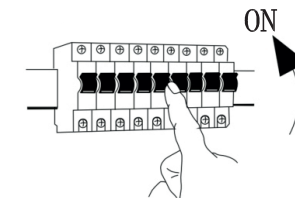

**8** Turn the power on at the mains supply board.

**YOUR DOWNLIGHT/S ARE NOW READY FOR USE.**



Appliances marked with this symbol must not be disposed of along with normal household refuse! You are legally bound to dispose of old appliances separately from household waste. Information about collection points where old appliances can be disposed of free of charge is available from your local authorities.

**SPECIFICATIONS**

**Protection:** Class II, IP44 (From the front of fitting when mounted)  
**Voltage:** 220-240V 50/60Hz  
**Max Power:** 9W including driver  
**Illuminant:** This item includes an integrated LED board which is non-replacable  
**Colour Temperature:** Switchable between 3000K, 4000K & 5000K  
**CRI (Ra):** >80  
**Cut-out size:** Ø90mm

**DISPOSAL**

The product and its packaging have been manufactured from valuable materials that can be recycled. Recycling reduces the amount of refuse and helps to preserve the environment. Dispose of the packaging at a recycling point that sorts materials by type. Make use of the local facilities provided for collecting paper, cardboard and packaging.

**WARNING-RISK OF FIRE, BURNS AND OTHER INJURIES**

The luminaires may become hot during use. Do not touch them, and never hang anything over or from it.

Do not use the light if the power cord or plug is damaged. If damaged, have it repaired by a service facility before use. If the plug does not fit the outlet, have a proper outlet installed by a qualified electrician.

**ANY NOTES**

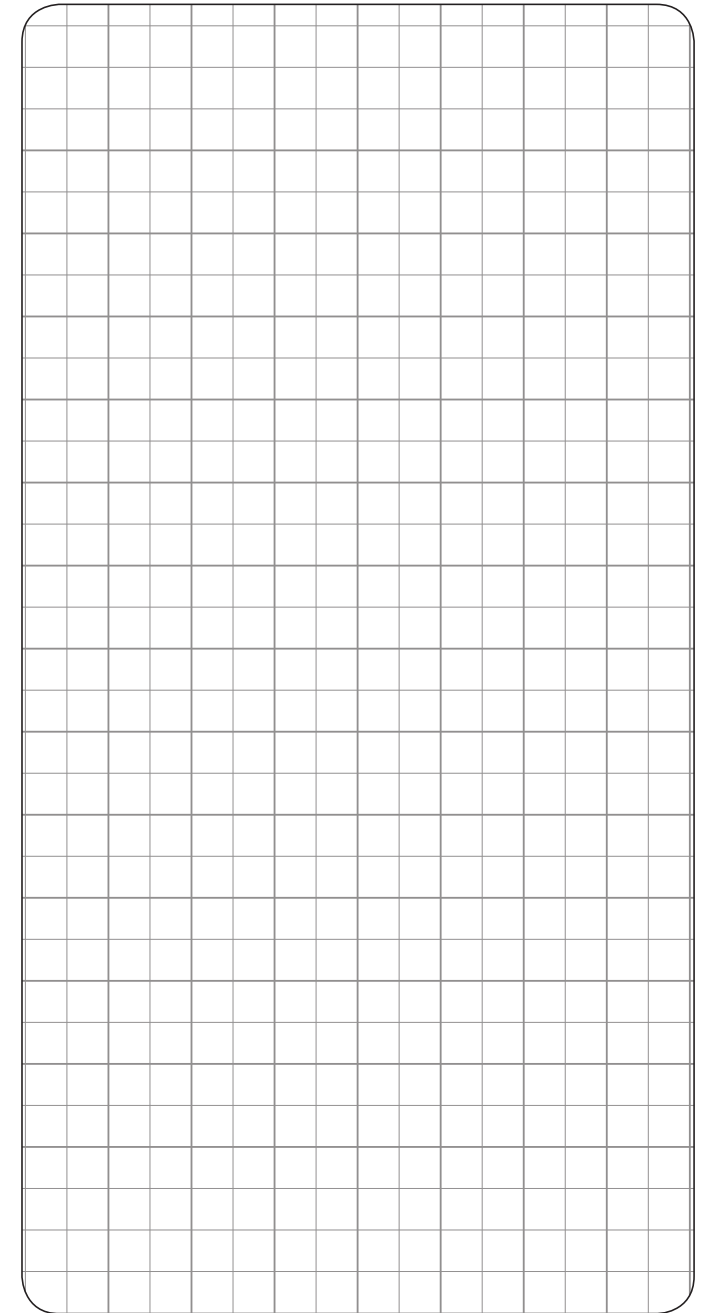

**EGLO Lighting Australia**  
5/339 Archerfield Road,  
Richlands, Queensland 4077  
Made in China  
[www.eglo.com.au](http://www.eglo.com.au)